



TAMBOUR DOOR SYSTEMS

CREATIVE, SPACE-SAVING CABINET SOLUTIONS

Contents

1.....	Freedom in Cabinet Design	4
2.....	Diversity in Cabinet Design	6
3.....	Profiles and Ranges	8
4.....	Horizontal Application	10
	Track Systems	12
	Classic Track Recessed System	14
	Flex Track Recessed System	16
	Top Basic Track Surface-Mounted System	18
	Top Track Surface-Mounted System	20
	Frame Track Overlay System	22
5.....	Vertical Application	24
	Mechanisms	26
	Caddy Brake	28
	Vertical Brake	30
	C6 Vertical Counterbalance	32
	C3 Counterbalance	34
	C3 Counterbalance Kit	38
6.....	Vetro Line	38
7.....	Acoustic Line	42
8.....	Quality and Service	46
9.....	Coordinating the Details	48
10.....	Article Overview	50

Are your furniture and display designs keeping pace with the most contemporary trends in the market? Discover how REHAU tambour door systems can give your products a fresh look and increased functionality.



Advantages of REHAU Tambour Door Systems

When compared with sliding or hinged doors, as well as with traditional metal or wood tambour doors, our polymer-based tambour door systems offer numerous advantages.

Practical

Give full access to cabinet contents.

Functional

Operate smoothly and quietly.

Space-Saving

Require minimal space with no doors that open out into the work area.

Unique Design

Provide endless possibilities for cabinet sizes, designs and finishes.

Reliable

Do not stick or swell with humidity.

Durable

Resist scratching better than hot stamped or foiled products.

Versatile

Suitable for new or retrofit applications.



Horizontal Application

Track System

Profile Depth

Rear Wall (RW)
Side Wall (SW)

Design Range

Metallic Line

Printed Line

Solid Line

Internally Mounted Track

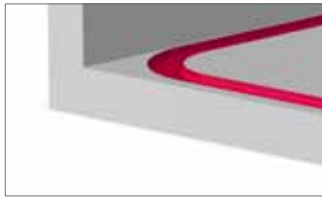

Recessed

Classic

Flex

8 mm



RW

SW

RW

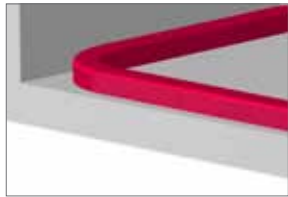

Fitted

Top

Top
Basic

8 mm

8 mm



RW

SW

RW

Front Mounted Track



Overlay

Frame

8 mm



RW

SW

conditionally recommended



Vertical Application

Profile Depth

Mechanism

Design Range

Vetro Line*

Metallic Line

Printed Line

Solid Line

Made-to-Measure Sizes

8 mm 8 mm 8 mm 8 mm



Caddy
Brake

⁽¹⁾

Vertical Brake

C6

⁽²⁾

C3

* Standard sizes ⁽¹⁾ 25 mm ⁽²⁾ 20 mm

Design ranges for style and function

Solid Line	White, gray and black
Printed Line	Aluminum, champagne, pine gray and walnut
Metallic Line	Aluminum and brushed stainless steel
Vetro Line	Green, black and white glass
Acoustic Line	Aluminum and white

Track systems for horizontal applications give design flexibility

Classic	Recessed
Flex	Recessed
Top Basic	Fitted
Top	Fitted
Frame	Overlay

Convenient mechanisms for vertical applications

For special designs you have the choice of the following mechanisms:

- Caddy brake
- Vertical brake
- C6 vertical counterbalance mechanism
- C3 vertical counterbalance mechanism

C3 kits are available for vertical application.



PROFILES AND DESIGN RANGES

Acoustic Line

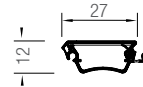
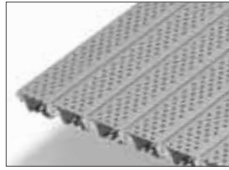

E23 Polymer Line

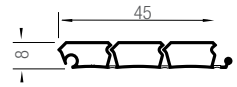

Profile Depth

12 mm

Design Range

Color

Acoustic Line

- Aluminum
- White



Vetro Line

- Green
- Black
- White



Metallic Line

- Aluminum
- Brushed Stainless Steel



Printed Line

- Aluminum
- Champagne
- Pine Gray
- Walnut

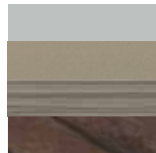

Solid Line

- White
- Gray
- Black



E9 Polymer Line

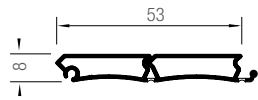
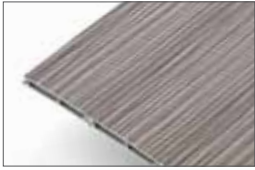

Metallic Line 20

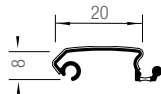

Metallic Line 25

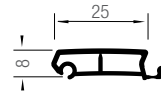

Vetro Line

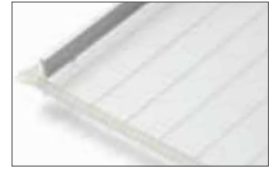

8 mm

Horizontal Application

Vertical Application



■ Available as 2.5 m lengths

■ Available as an installation-ready set from the warehouse

■ Available in C3 kits

REHAU offers a complete system for nearly every type of horizontal tambour door application. The combination of tracks and profiles gives you the flexibility to create doors with cohesive style and function for any space. Rear and side-wall orientations allow for maximized storage options based on cabinet size.



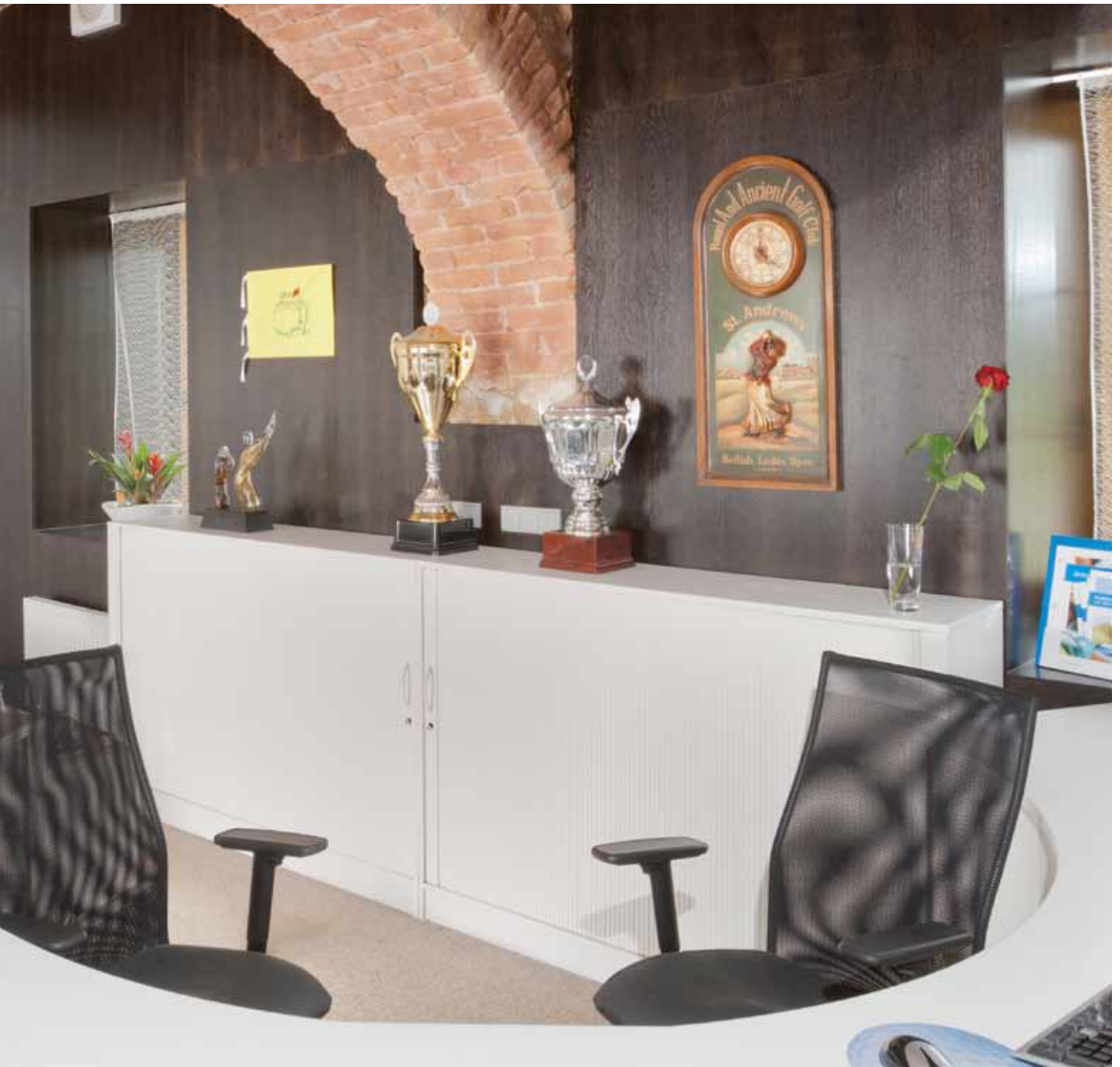

HORIZONTAL APPLICATION

TRACK SYSTEMS

Internally Mounted Track

Recessed

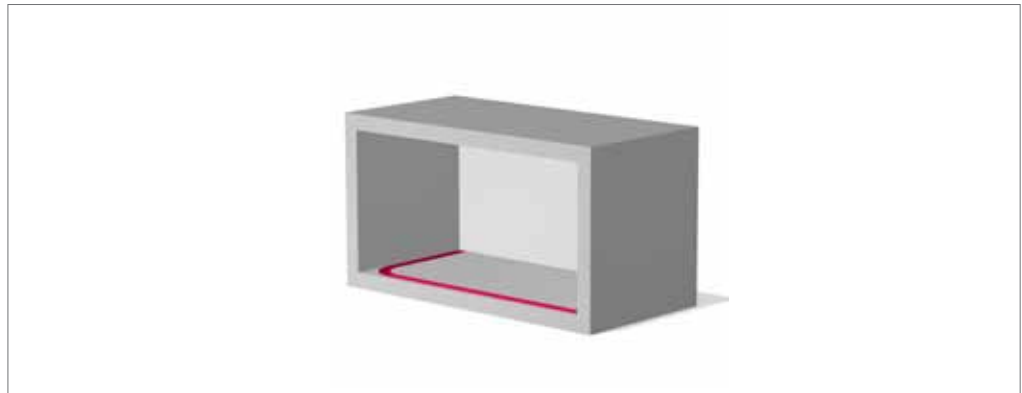

Classic Recessed

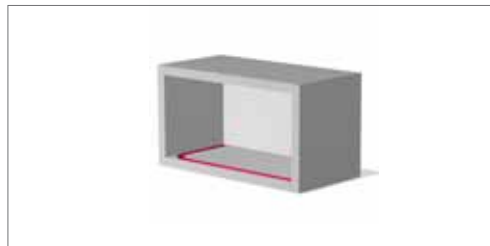

Flex Recessed



- Classic track technology
- Recessed track
- A choice of running direction into the rear wall or the side wall

- Freedom in cabinet design due to new contoured capabilities
- Flexible, recessed track
- Any outward curved running direction
- Minimum internal radius $R_i = 35.5$ mm
- Possible to cold-bend the track by hand

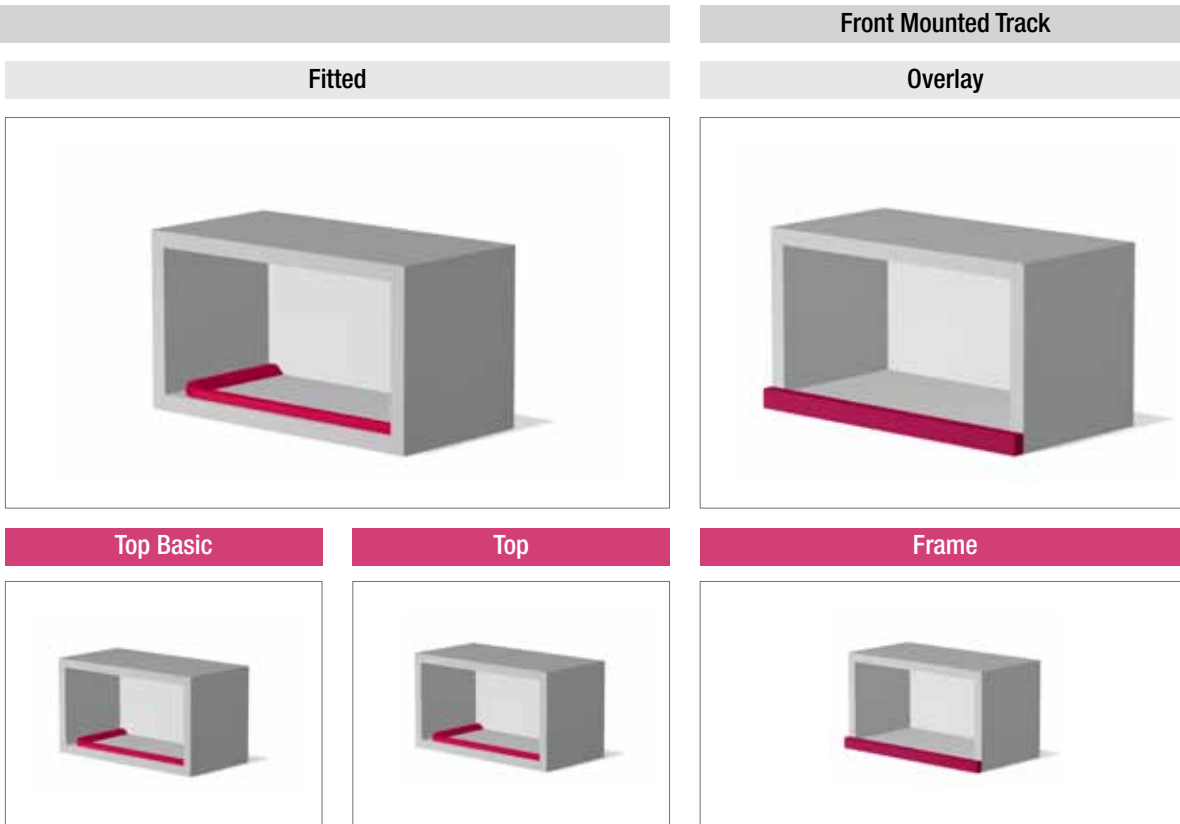

- Easy assembly
- No milling, just cut into lengths and screw
- Can also be assembled as a retrofit
- Track systems in solid colors

- Easy assembly
- No milling, just cut into lengths and screw
- Can also be assembled as a retrofit
- High-quality appearance, due to no visible crossover between track/spiral/90° corner
- Tracks in aluminum; covers available in solid colors

- Impressive framed design
- Easy assembly: no milling, just cut into lengths and screw
- Standard front design for horizontal and vertical cabinets
- Track system (19 mm) appears flush to standard hinged doors

HORIZONTAL APPLICATION

CLASSIC TRACK RECESSED SYSTEM



- Classic track technology
- Recessed track
- A choice of running direction into the rear wall or the side wall

	8 mm Thick Profiles
Profile Type	
E23 Polymer Line	■
E9 Polymer Line	■
Metallic Line 20	■
Metallic Line 25	■
Design Line	
Metallic Line	■
Printed Line	■
Solid Line	■



Recommended Areas of Application

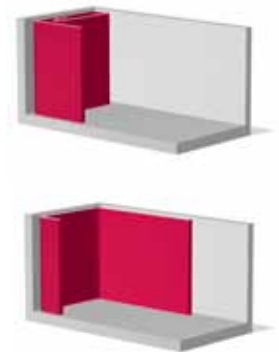
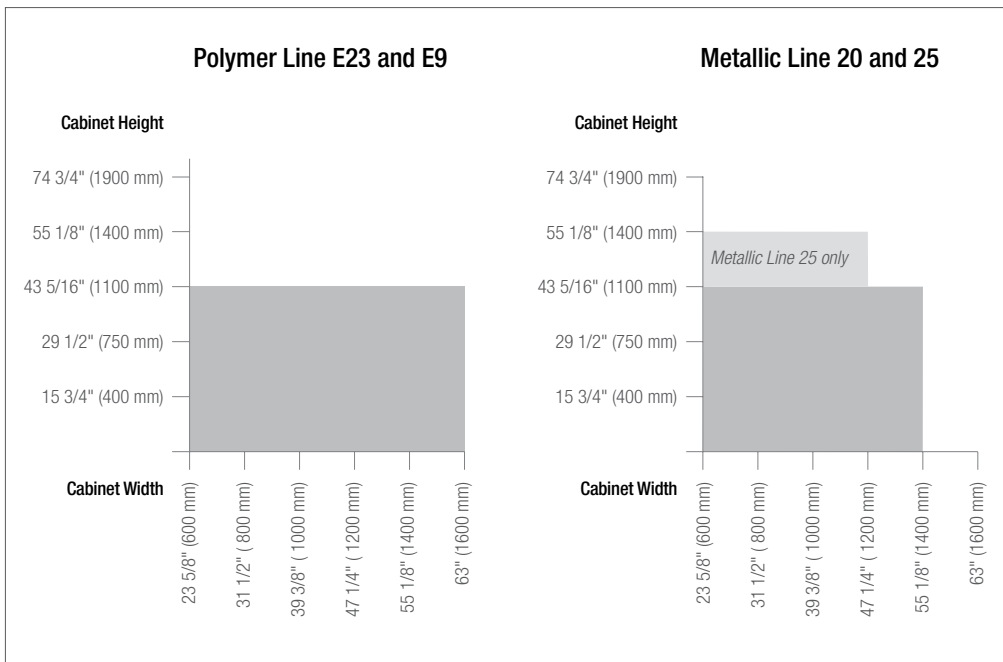

HORIZONTAL APPLICATION

FLEX TRACK RECESSED SYSTEM



- Freedom in cabinet design due to new contoured capabilities
- Flexible, recessed track
- Any outward curved running direction
- Minimum internal radius $R_i = 35.5$ mm
- Possible to cold-bend the track by hand

	8 mm Thick Profiles
Profile Type	
E23 Polymer Line	■
E9 Polymer Line	■
Metallic Line 20	■
Metallic Line 25	■
Design Range	
Metallic Line	■
Printed Line	■
Solid Line	■

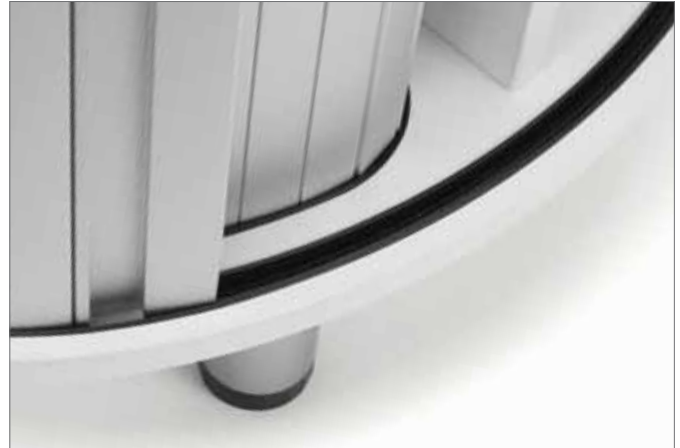

Recommended Areas of Application

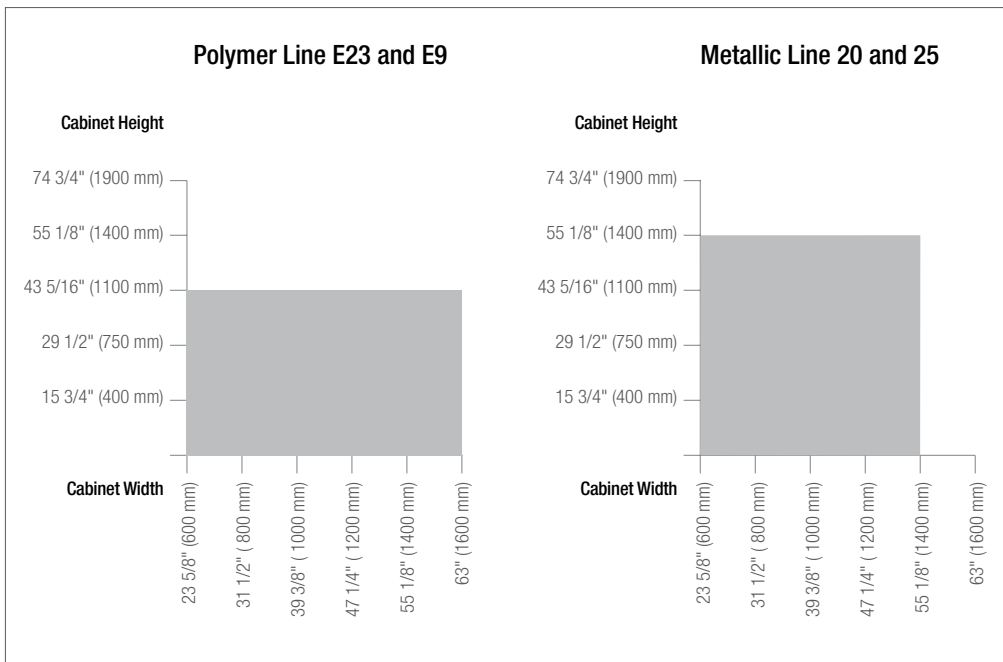

HORIZONTAL APPLICATION

TOP BASIC TRACK SURFACE-MOUNTED SYSTEM



- Easy assembly
- No milling, just cut into lengths and screw
- Can also be assembled as a retrofit
- Track systems in solid colors

	8 mm Thick Profiles
Profile Type	
E23 Polymer Line	■
E9 Polymer Line	□
Metallic Line 20	□
Metallic Line 25	□
Design Range	
Metallic Line	□
Printed Line (track system in solid)	□
Solid Line	■

□ Certain conditions may apply



Recommended Areas of Application

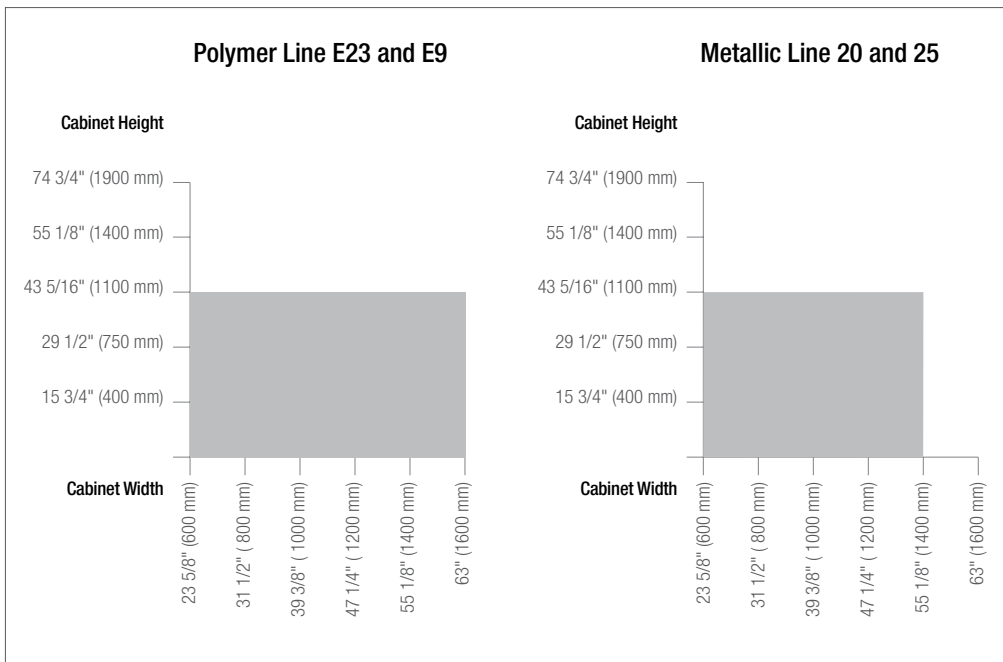

HORIZONTAL APPLICATION

TOP TRACK SURFACE-MOUNTED SYSTEM



- Easy assembly
- No milling, just cut into lengths and screw
- Can also be assembled as a retrofit
- High-quality appearance, due to no visible crossover between track/spiral/90° corner
- Tracks in aluminum; covers available in solid colors

8 mm Thick Profiles	
Profile Type	
E23 Polymer Line	■
E9 Polymer Line	
Metallic Line 20	■
Metallic Line 25	■
Design Range	
Metallic Line	■
Printed Line	■
Solid Line	■



Recommended Areas of Application

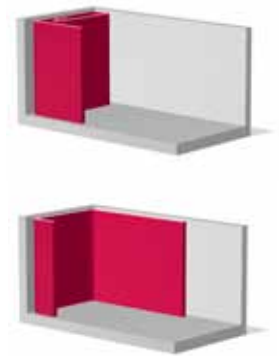
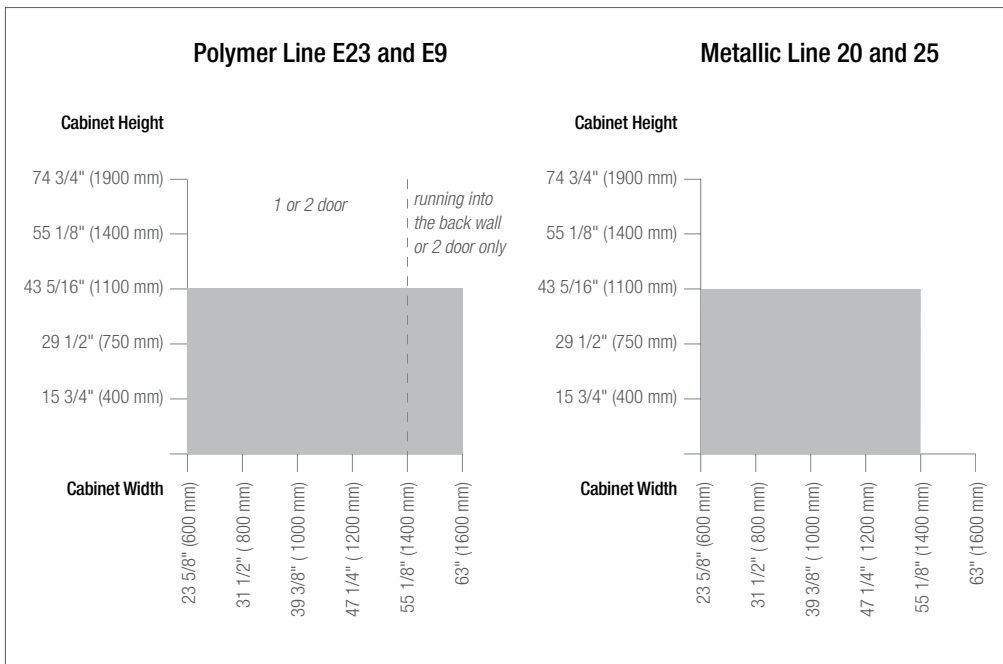

HORIZONTAL APPLICATION

FRAME TRACK OVERLAY SYSTEM



- Impressive framed design
- Easy assembly: no milling, just cut into lengths and screw
- Standard front design for horizontal and vertical cabinets
- Overlay track system (19 mm) appears flush to standard hinged doors

	8 mm Thick Profiles
Profile Type	
E23 Polymer Line	■
E9 Polymer Line	
Metallic Line 20	■
Metallic Line 25	■
Design Range	
Metallic Line	■
Printed Line	■
Solid Line	■



Recommended Areas of Application

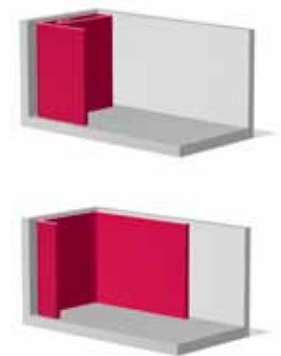
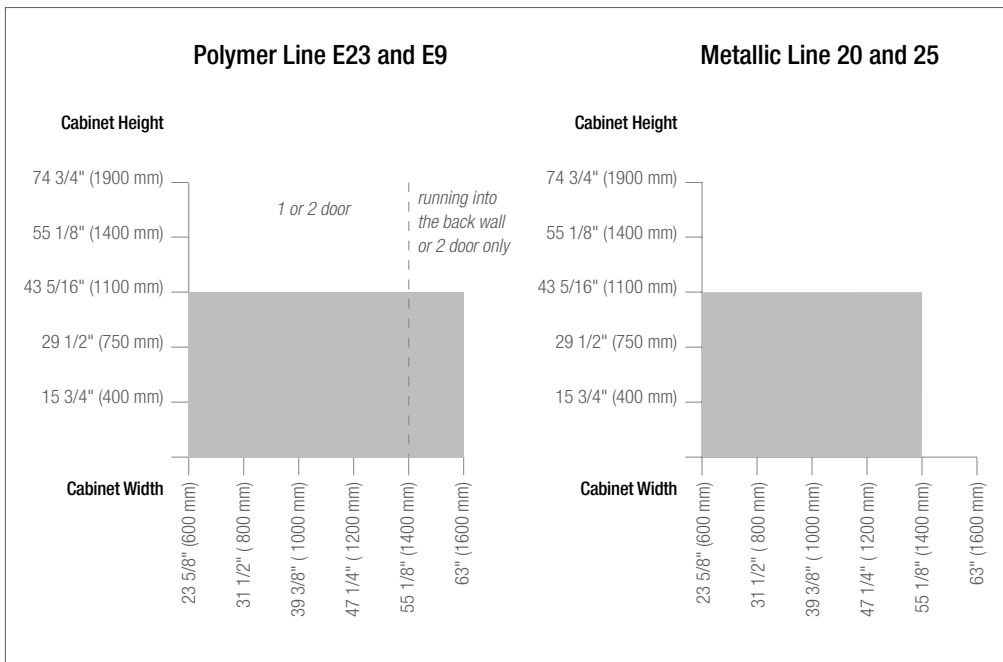

REHAU offers a complete system for nearly every type of vertical tambour door application. When combining components, you have a variety of possibilities for the design of your cabinet. Our selection of counterbalance systems satisfies a broad range of requirements – from small caddies to wall cabinets in offices to demanding kitchen and store fixture applications. Design and functionality are at the forefront of every combination.





VERTICAL APPLICATION

MECHANISMS



Mechanism				
				
	Caddy Brake	Vertical Brake	C6	C3
Running Direction				
Back wall		■	■	■
Spiral	■	■		
Track System				
Classic	■	■	■	■
Flex		■	□	□
Top Basic		□	■	■
Top	■	□	■	■
Frame	■	□	■	■

□ Certain conditions may apply

VERTICAL APPLICATION

CADDY BRAKE



- Application in wooden cabinets with recessed or fitted tracks and spirals
- Braking module for direct installation
- Easy assembly with minimal preparation effort
- Opening direction from top to bottom
- Possible to make adjustments from the outside in cabinets that have already been assembled
- One brake per cabinet is sufficient; if necessary, a second brake can be added on opposite side
- Application with E23 Polymer Line and Metallic Line 25

	Track System				
	Classic	Flex	Top Basic	Top	Frame
Profile Depth	8 mm	8 mm	8 mm	8 mm	8 mm
Running Direction					
Back wall				■	
Spiral	■				■
Profile Type					
E23 Polymer Line	■			■	■
Metallic Line 20					
Metallic Line 25	■			■	■
Design Range					
Solid Line	■			■	■
Printed Line	■			■	■
Metallic Line	■			■	■



Recommended Areas of Application

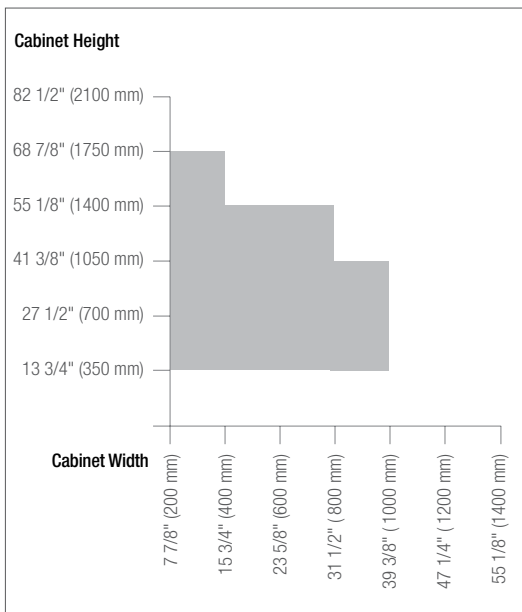

Art. No. 779640

VERTICAL APPLICATION

VERTICAL BRAKE



- Double functions as a handle glide especially for small cabinets
- Brakes the run of the tambour on opening and closing
- Braking effect on both sides and ends of handle
- Can be combined with handle Art. No. 779330 and Art. No. 779340
- Application with E23 Polymer Line

	Track System				
	Classic	Flex	Top Basic	Top	Frame
Profile Depth	8 mm	8 mm	8 mm	8 mm	8 mm
Running Direction					
Back wall	■	■	□	□	□
Spiral	■	■			
Profile Type					
E23 Polymer Line	■	■	□	□	□
Metallic Line 20					
Metallic Line 25					
Design Range					
Solid Line	■	■	□	□	□
Printed Line	■	■	□	□	□
Metallic Line					



□ Certain conditions may apply

Recommended Areas of Application

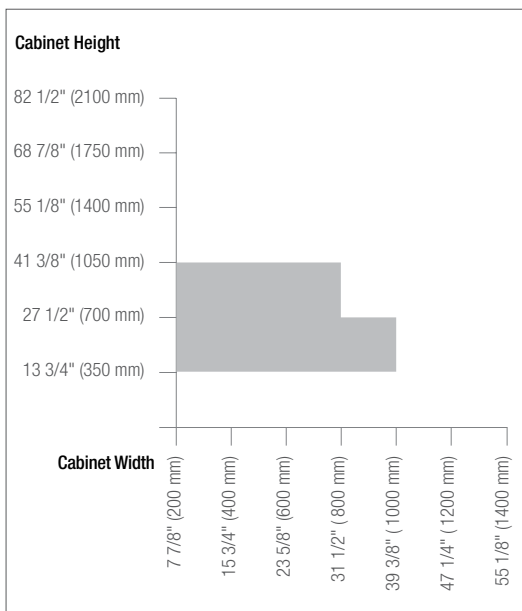

Art. No. 779680

VERTICAL APPLICATION

C6 VERTICAL COUNTERBALANCE



Courtesy of Martela

- Application in wooden cabinets with recessed or fitted tracks and running direction into the rear wall
- Active weight balancing for opening from bottom to top
- Simple solution with minimum space required in the cabinet
- Application with E23 Polymer Line and Metallic Line 20

	Track System				
	Classic	Flex	Top Basic	Top	Frame
Profile Depth	8 mm	8 mm	8 mm	8 mm	8 mm
Running Direction					
Back wall	■	□	■	■	■
Spiral					
Profile Type					
E23 Ploymer Line	■	□	■	■	■
Metallic Line 20	■	□		■	■
Design Range					
Solid Line	■	□	■	■	■
Printed Line	■	□	■	■	■
Metallic Line	■	□		■	



□ Certain conditions may apply

Recommended Areas of Application

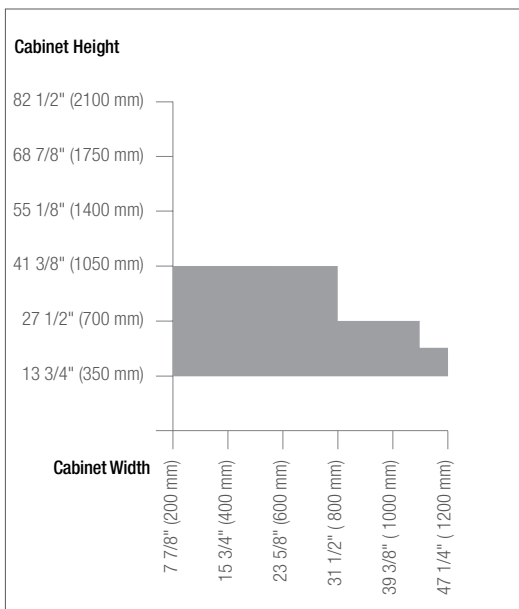

Art. No. 779970

VERTICAL APPLICATION

C3 COUNTERBALANCE

Complete system for vertical application:

- Convenient running properties
- Optimal weight balancing of the tambour door due to high-quality counterbalance mechanism
- Minimal space required for all cabinet heights
- Area of application up to max. 6 shelf heights
- Increased flexibility from 350 to 1,233 mm interior width as a result of extension
- Application with E23 Polymer Line and Metallic Line 20 and 25





By courtesy of Ebke

VERTICAL APPLICATION

C3 COUNTERBALANCE



You can design a made-to-measure C3 roller mechanism via the tambour door configurator, combine modules yourself or order a standard set.



Recommended Areas of Application:

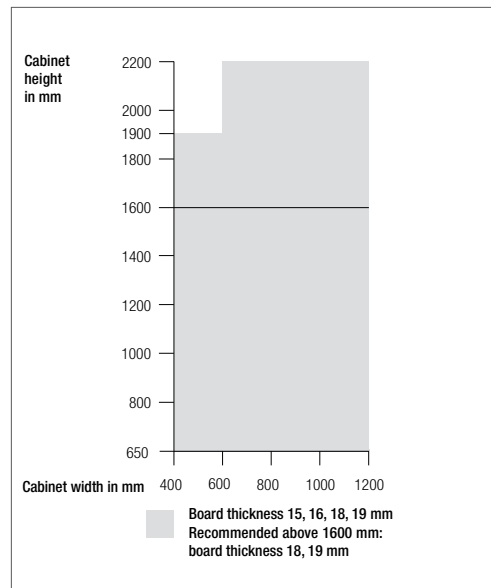

VERTICAL APPLICATION

C3 COUNTERBALANCE KIT



C3 counterbalance tambour door system kits are part of a wide range of design solutions available from our Express Collection stock program.

The ready-to-assemble kits include all system components for quick, convenient, out-of-the box cabinet installation.

Sizes Available

Width	400 mm	18 in	500 mm	21 in	550 mm	600 mm	24 in	700 mm	30 in	800 mm	900 mm	36 in	1000 mm	42 in	1200 mm	48 in
Height	48	•	•	•	•	•	•	•	•	•	•	•	•	•	•	•
in	60	•	•	•	•	•	•	•	•	•	•	•	•	•	•	•
	72	•	•	•	•	•	•	•	•	•	•	•	•	•	•	•
	82						•	•	•	•	•	•	•	•	•	•

Note: Sizes for C3 kits are calculated as outside cabinet dimensions with 3/4" (19 mm) board thickness leaving a 3 mm reveal to ensure alignment with surrounding cabinets.

VETRO LINE

THE FASCINATION OF GLASS

A modern premium kitchen design is simply not complete without the use of glass doors and translucent materials. REHAU's Vetro Line tambour door system combines the easy installation of the REHAU cassette system and the design element of pure glass for a very refined solution. The pre-configured cassette system only requires a few screws to secure it in place, and the result is a ready-to-use, premium cabinet.





VETRO LINE

GLASS TAMBOUR DOOR SYSTEM



Vetro Line offers significant advantages in terms of function and design.

The system perfectly combines the ease of installation and the excellent running properties of the reliable REHAU cassette systems and the design aspect of glass. ESG (tempered safety glass) provides a tough surface for heavy loads and resists cracking. Using 50 mm wide slats, Vetro Line creates a harmonious, translucent and two-dimensional front. Both glass and frame profiles are easy to clean and provide a cool aluminum touch as well as a high-quality look. REHAU expertise is also hidden behind the slats: in the form of the reliable C5 vertical counterbalance mechanism.

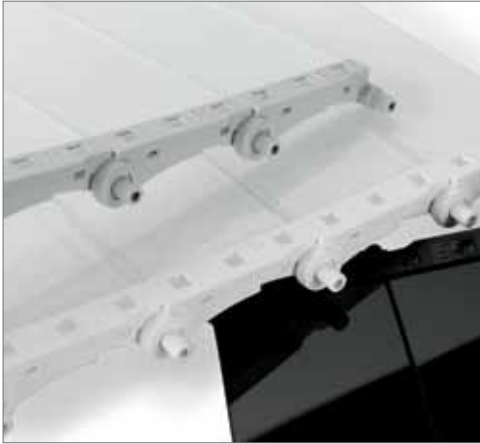

Sizes Available

	Slat Width	Mechanism	Surface Accessories	Height 1000 mm			Height 1500 mm		
				Green	Black	White	Green	Black	White
Width 600 mm	50 mm	C-Box	Aluminum	■	■	■	■	■	■
Width 900 mm	50 mm	C-Box	Aluminum	□	□		■	□	□
Running Tracks	16 mm	□							
Running Tracks	19 mm	■							

- Express Collection Stocked
- Custom Production

ACOUSTIC LINE

INTELLIGENT SOUND-ABSORBING SOLUTION



REHAU Acoustic Line improves office environments through the intelligent combination of acoustical materials and furniture.

The desire for openness, transparency and space-related flexibility has unbalanced the acoustics in today's workplaces. The modern trend for large open-plan offices requires innovative technical solutions to reduce sound propagation. The battle between free exchange of information and required concentration presents a considerable challenge for flexible room acoustics.

When it comes to shielding sound, reducing noise disturbance levels and minimizing reverberation time, REHAU Acoustic Line is the ideal technical solution.

Acoustic Line uses a special profile with punched holes in the front face, behind which sits an acoustic non-woven fleece. The acoustic fleece inside the profile acts as an absorption material, soaking up the sound wave energy as it enters the profile and preventing it from re-emerging. As a result, a REHAU Acoustic Line cabinet absorb up to 80% of the sound that come in contact with it, which is almost 7 times the absorption capacity of a conventional cabinet.

The special feature of the product is its linear absorption across the whole frequency range. The broad-band absorber is especially effective at absorbing deep and high tones in addition to the speech-related frequency ranges.



ACOUSTIC LINE

INTELLIGENT SOUND-ABSORBING SOLUTION



- Flexible layout which allows sound to be reduced directly at the source of the noise
- Sound shielding and absorption in the proximity of the employee
- Produced using polypropylene (PP) material
- Optimizes space saving by combining acoustic and functional design
- Broadband absorber helps greatly reduce sound reverberation time

	12 mm Thick Profiles*
Profile Type	
E23 Polymer Line	
E9 Polymer Line	
Metallic Line 20	
Metallic Line 25	
Acoustic Line	■
Design Range	
Acoustic Line	■
Metallic Line	
Printed Line	
Solid Line	



* Can be used with 8 mm track with extra processing

Recommended Areas of Application

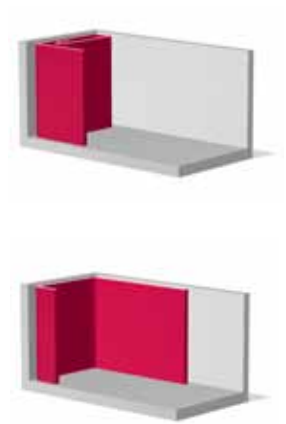
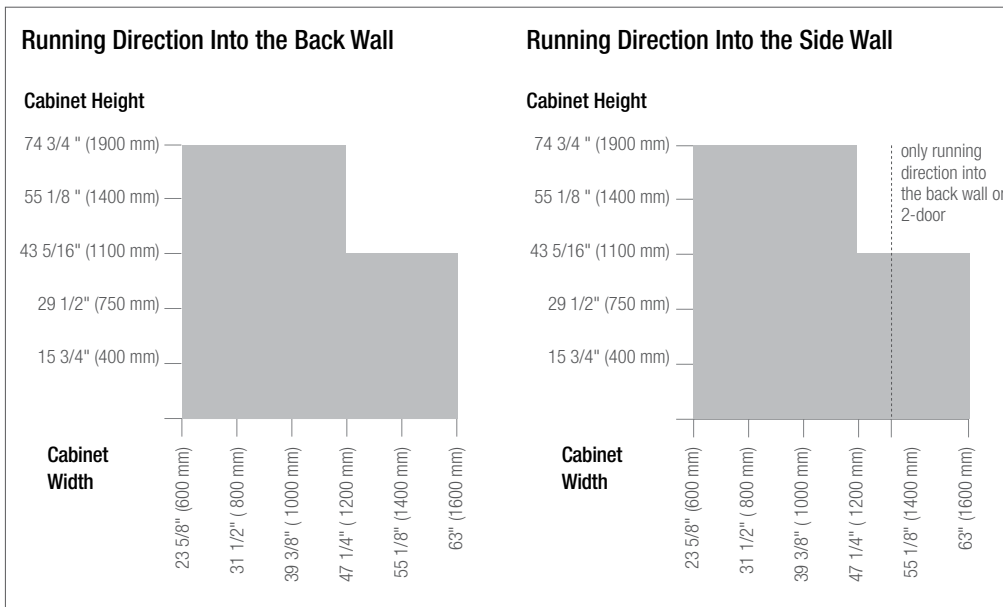

QUALITY AND SERVICE

REHAU'S CUSTOMER COMMITMENT



Quality Management

REHAU's quality management system is based on a range of demanding requirements, including those stipulated by ISO 9001 and ISO/TS 16949.

Research and Innovation

As a leading polymer processor, REHAU operates in an innovative and technology-oriented environment. Decades of experience combine with our core competencies in material development, system design and surface technology to make us a leading innovator of furniture products.

Independence

By focusing on medium- and long-term goals rather than on short-term profits, REHAU is a steady and dependable business partner. With an emphasis on stable growth, we target industries and regions that promise long-term potential. Economies of scale and sharing knowledge across industries give REHAU a strategic advantage.

Environmental Stewardship

Environmental protection concepts play an important role in our product development and design. At every stage of development, we consider recycling options – from designing products using recycled content to improving product recyclability to increasing a product's longevity. Our production plants also set environmental targets and several have achieved ISO 14001 certification for their environmental management systems.



Central Customer Service Centers

Customer service centers with highly trained sales staff have been established for the US and Canada to provide fast and reliable answers to all order-related questions.

Central Distribution Centers

Through central distribution centers in the US and Canada, REHAU offers a 24-hour turn around for stocked articles. For orders received before noon, 90% ship the same day.

REHAU Academy Events

REHAU Academy is a unique program that allows you to take advantage of the expertise of our local sales personnel to maximize your success with our unique product range. We facilitate on-site training for you and your customers on the REHAU product range, trends in the industry as well as technical and process improvements.

REHAU Technical Support Service

With 30 plus years of experience in the application of edgebanding, REHAU technical staff is available to answer technical questions.

9

COORDINATING THE DETAILS

DESIGNING IN METALLIC

Attention to detail is an important part of kitchen design.

Gone are the days when a series of components with different surface finishes had to be laboriously matched to one another, because REHAU'S metallic range coordination guide allows you to work with uniform surface finishes and individual highlights.

Whether it's aluminum or our exclusive brushed stainless steel finish, REHAU offers real value across the entire range of products. The careful selection of materials ensures that edgebands, tambour doors, wall seal systems and plinth covers are matched to create furniture with a uniformly stylish look.



Once again, the best of both worlds – functionality and the ease of fabrication of polymer materials – combines to emulate the design quality and feel of solid aluminum.



1 Tambour Door Systems

The stylish aluminum finish provides highlights in any room.



2 Edgebanding

Edgeband that can be applied around tight radii and does not require re-working, with a genuine aluminum surface.



3 Backsplash Systems

Wall seal profiles that add a stylish touch to work-tops, even in the smallest alcoves.

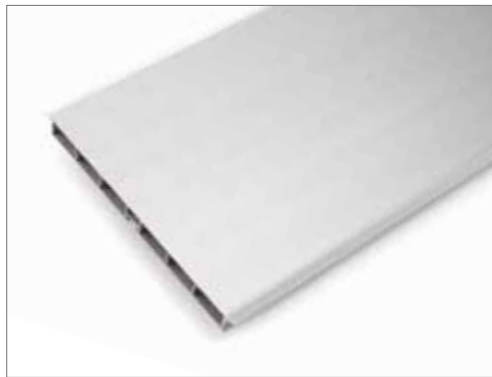

4 Plinth Cover Systems

Hollow-chambered profiles with a soft transparent sealing lip that creates a reliable barrier against dirt and moisture.

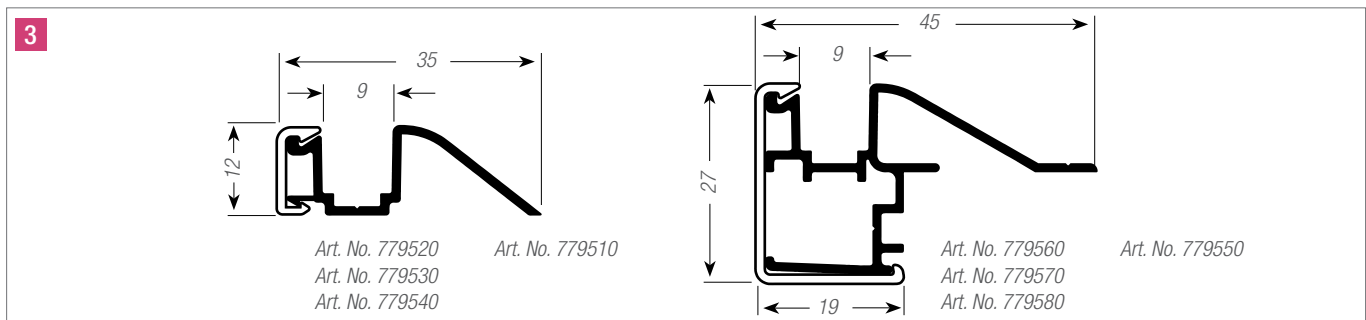
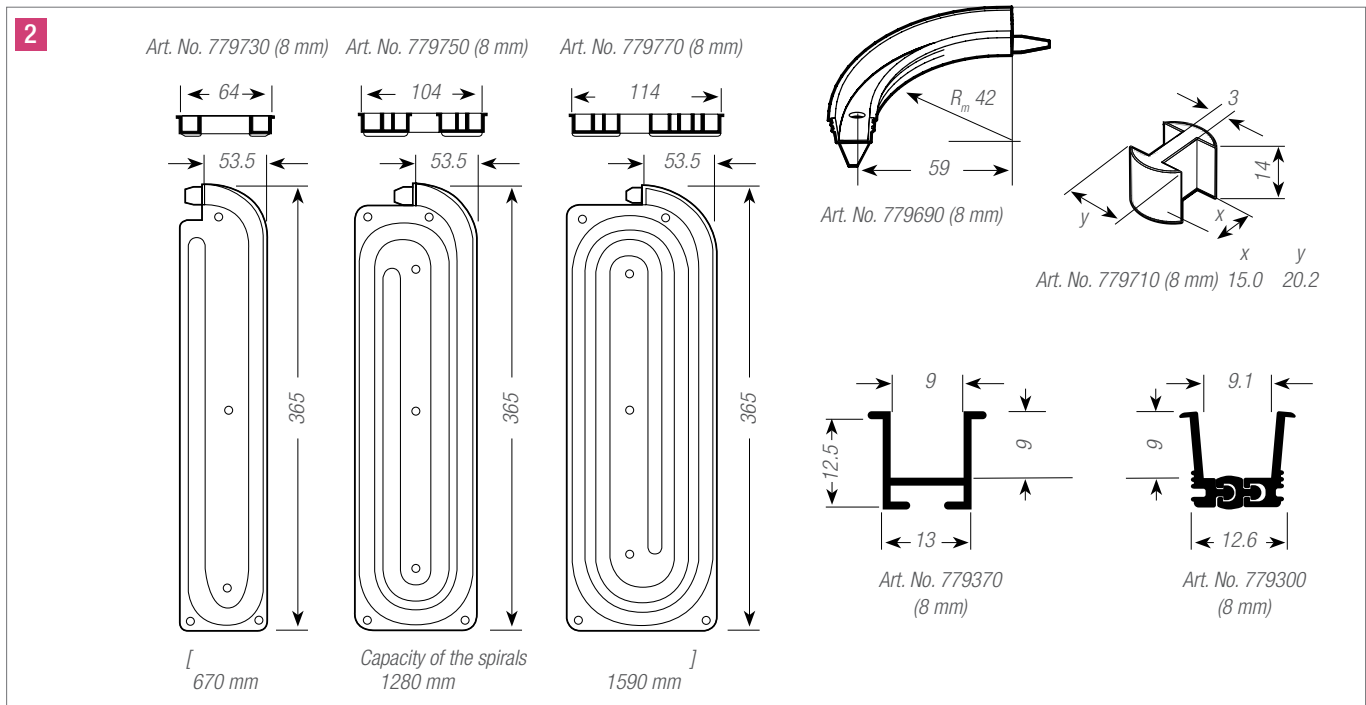
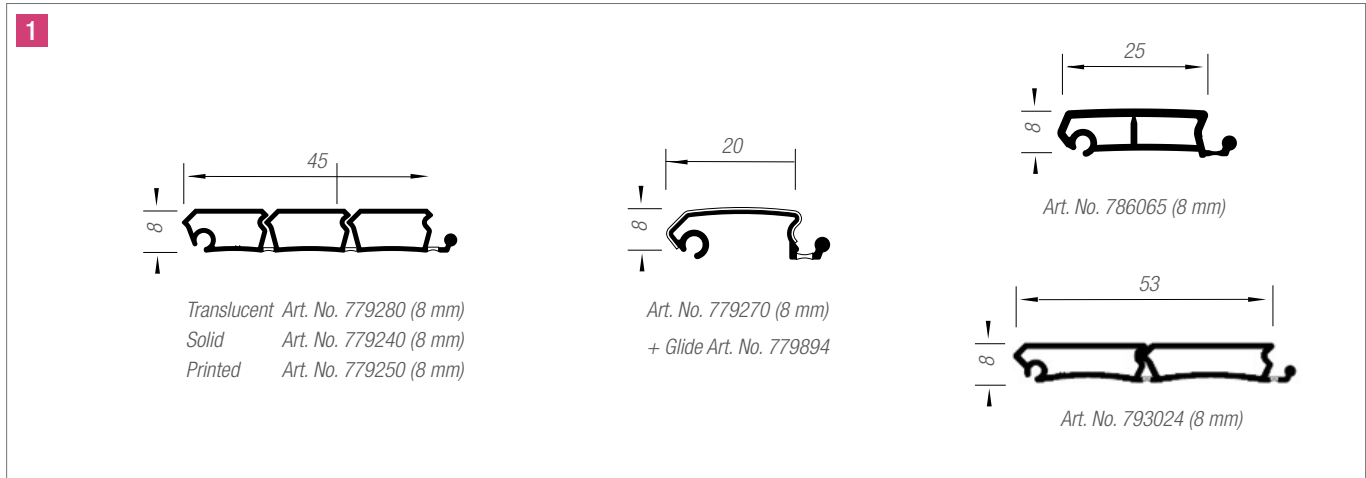

Note: All dimensions are in mm

Article Number	Article Description	Material	Profile Length	Packaging	Solid Line			Printed Line				Metallic Line		Acoustic Line	
					White	Gray	Black	Aluminum	Champagne	Pine Gray	Walnut	Aluminum	Brushed Stainless Steel	White	Aluminum

1 Tambour Door Profiles															
779240	E23 Solid	RAU-PVC	2.5 m	88 lg	9010	7035	9011								
779250	E23 Printed	RAU-PVC	2.5 m	88 lg				5427	1100E						
793024	E9 Printed	RAU-PP	2.5 m	66 lg				7194		1243W	1705W				
786172	Metallic Line 20	Alu	2.5 m	240 lg								360L			
779270	Metallic Line 20	Alu/ RAU-PP	2.5 m	240 lg								230L (E6EV1)			
786065	Metallic Line 25	Alu/ RAU-PP	2.5 m	168 lg								230L (E6EV1)	360L		

2 CLASSIC and FLEX Track Systems															
779370	8 mm Track	RAU-PVC	2.5 m	20 lg	9010	7035	9011								
779300	8 mm Flexible track	RAU-PP	2.5 m	20 lg		7035	98001								
779710	Center stopper 8 mm	RAU-PA		40 pcs	9010	7035	9011								
779690	90° Connector 8 mm	RAU-PA		40 pcs	9010	7035	9011								
779730	Spiral 8 mm 2-way	RAU-PA		40 p			9011								
779750	Spiral 8 mm 4-way	RAU-PA		20 p		7035	9011								
779770	Spiral 8 mm 5-way	RAU-PA		20 p			9011								

3 TOP and FRAME Track Systems															
779510	TOP aluminum track	Alu	2.5 m	8 lg								230L (E6EV1)			
793015	TOP track, stainless steel	Alu	2.5 m	8 lg								360L			
779530	TOP solid cover	RAU-PVC	2.5 m	8 lg	9010	7035	9011								
779540	TOP printed cover	RAU-PVC	2.5 m	8 lg				5427							
779520	TOP aluminum cover	Alu	2.5 m	8 lg								230L (E6EV1)			
793001	TOP stainless steel cover	Alu	2.5 m	8 lg								360L			
779550	FRAME aluminum track	Alu	2.5 m	8 lg											
793016	FRAME track; stainless steel	Alu	2.5 m	8 lg											
779570	FRAME solid cover	RAU-PVC	2.5 m	8 lg	9010	7035	9011								
779580	FRAME printed cover	RAU-PVC	2.5 m	8 lg				5427							
779560	FRAME aluminum cover	Alu	2.5 m	8 lg								230L (E6EV1)			
793009	FRAME stainless steel cover	Alu		10 set								360L			
779630	FRAME end caps	RAU-POM		10 set	9010	7035	9011	38261							
793010	FRAME intake guide	RAU-POM		10 p			9011								

lg = lengths, p = pairs, pcs = pieces

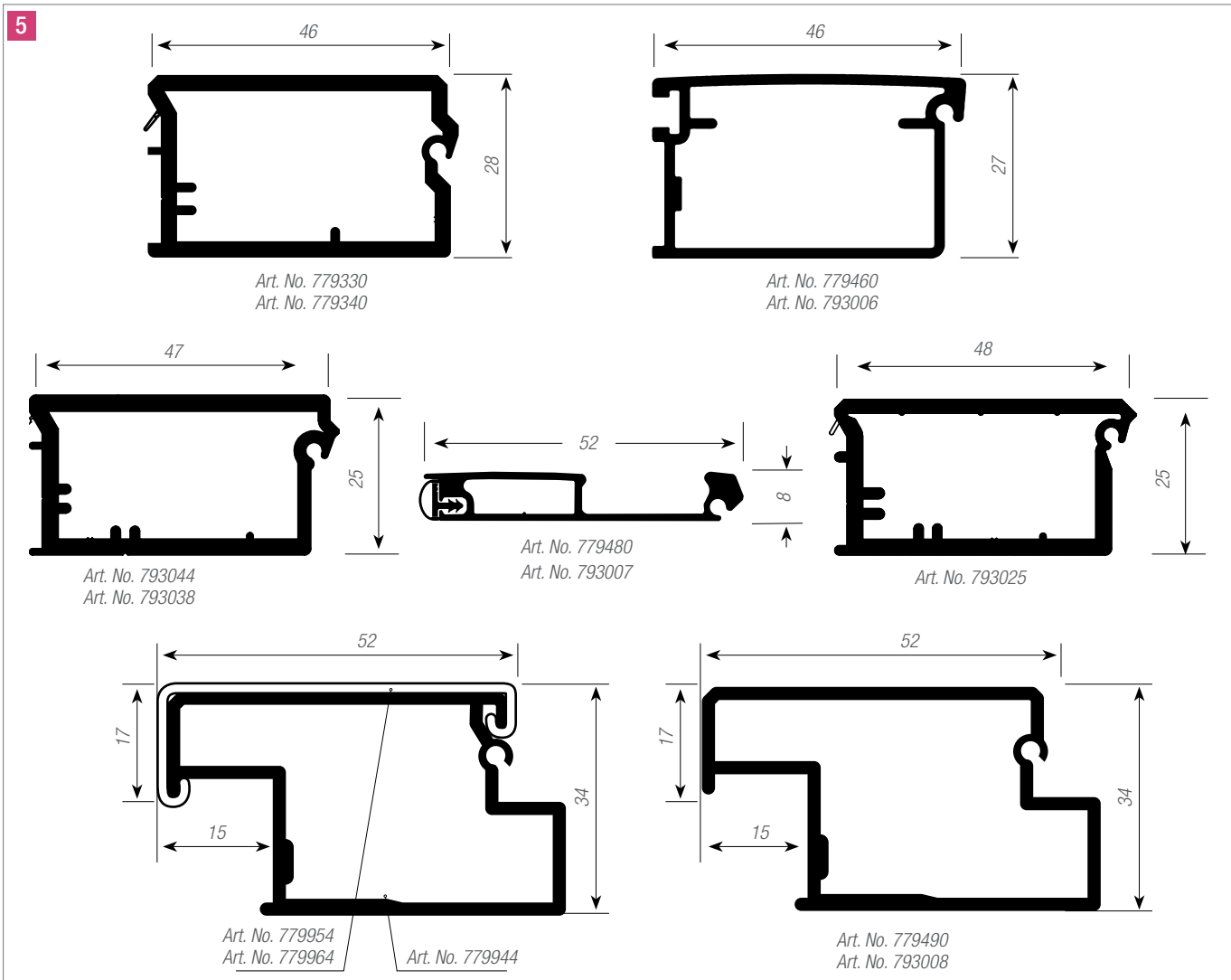
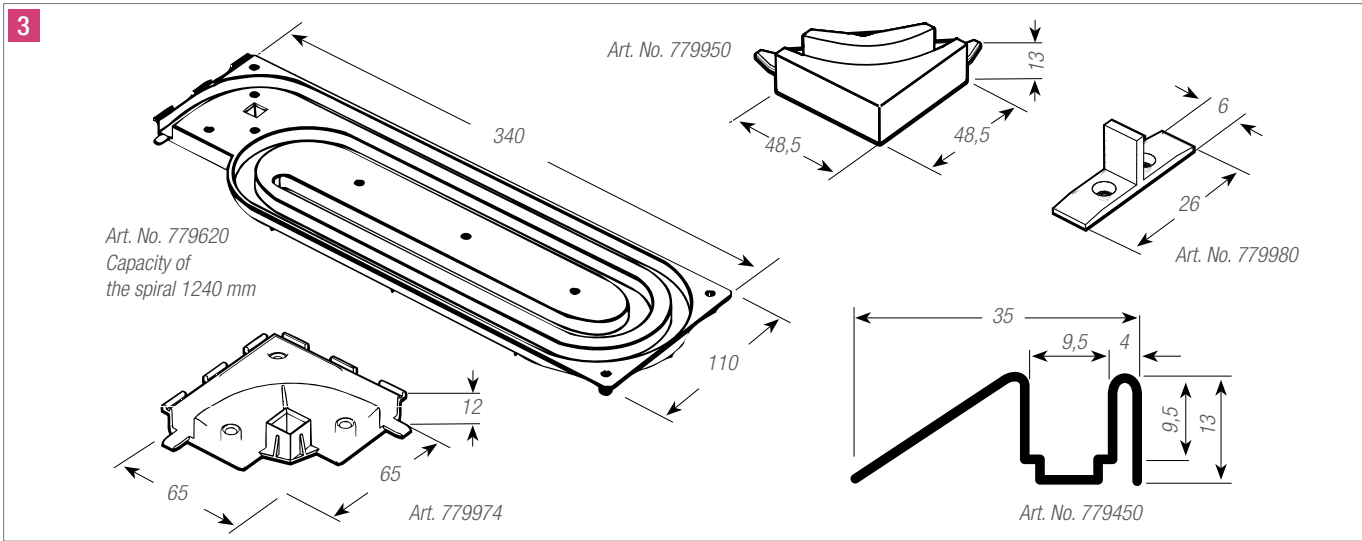

Note: All dimensions are in mm

Article Number	Article Description	Material	Profile Length	Packaging	Solid Line			Printed Line				Metallic Line		Acoustic Line	
					White	Gray	Black	Aluminum	Champagne	Pine Gray	Walnut	Aluminum	Brushed Stainless steel	White	Aluminum

3 TOP and FRAME Track Systems															
779620	TOP/FRAME spirals 4-way	RAU-PA		20 p			9011								
779974	TOP/FRAME 90° corner	RAU-PA		40 pcs			9011								
779980	TOP center stopper	RAU-PA		40 pcs	9010	7035	9011	38261							
779450	TOP BASIC track 8 mm	RAU-PVC	2.5 m	20 lg			9011	38261							
779950	TOP BASIC 90° connector 8 mm	RAU-PA		40 pcs			9011	38261							

4 C3 Tracks															
779880	Vertical track 19 mm	Alu	2.3 mm	1 p								230L			
793030	End caps for track 779880		15.5 m	20 p				9006							

5 Handles															
779330	Solid handle	RAU-PVC	2.5 m	8 lg	9010	7035	9011								
779340	Printed handle	RAU-PVC	2.5 m	8 lg				5427	1100E						
779660	Handle glide 8 mm	RAU-POM		20 p	9010	7035	9011								
779460	Aluminum handle	Alu	2.5 m	8 lg								230L (E6EV1)			
793006	Stainless steel handle	Alu	2.5 m	8 lg								360L			
779904	Aluminum handle glide	RAU-POM		20 p			9011								
779480	Aluminum combi handle	Alu	2.5 m	8 lg								230L (E6EV1)			
793007	Stainless steel combi handle	Alu	2.5 m	8 lg								360L			
779914	Combi handle glide	RAU-POM		20 p		7037									
779944	Aluminum frame handle lower part	Alu	2.5 m	8 lg								mill-finish (EQ/CO)			
779954	Solid handle frame cover	RAU-PVC	2.5 m	8 lg	9010	7035	9011								
779964	Printed handle frame cover	RAU-PVC	2.5 m	8 lg				5427							
779490	Aluminum frame handle	Alu	2.5 m	8 lg								230L (E6EV1)			
793008	Stainless steel frame handle	Alu	2.5 m	8 lg								360L			
779884	Frame handle glide	RAU-POM		20 p		7035	9011								
793025	Flush printed handle for E9	RAU-PP	2.5 m	8 lg				7194		1243W	1705W				
793019	Handle glide for flush handle	RAU-POM		20 p			9011								
793044	Solid Acoustic Line handle	RAU-PP	2.5 m	8 lg										V1865	
793038	Printed Acoustic Line handle	RAU-PP	2.5 m	8 lg											7194
793037	Handle glide for Acoustic Line	RAU-POM		20 p			9011								

lg = lengths, p = pairs, pcs = pieces

5

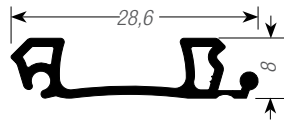

Art. No. 793060 Art. No. 779920

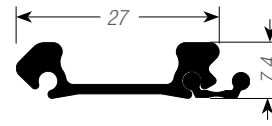

Art. No. 779930

6

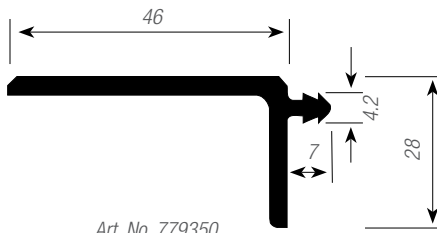

Art. No. 779350
Art. No. 779360

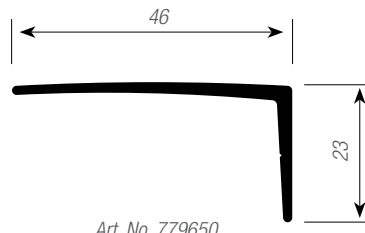

Art. No. 779650

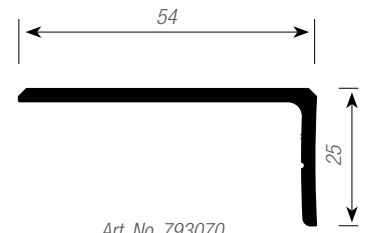

Art. No. 793070
Art. No. 793080

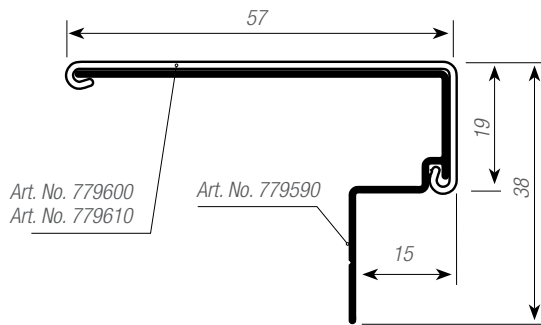

Art. No. 779600
Art. No. 779610

Art. No. 779590

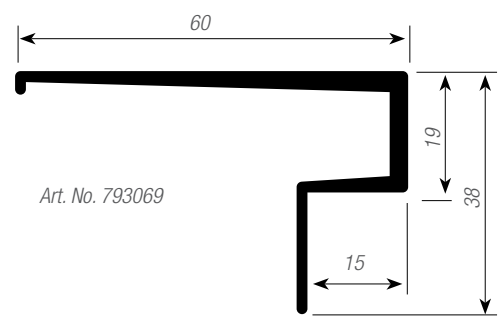

Art. No. 793069

Note: All dimensions are in mm

Article Number	Article Description	Material	Profile Length	Packaging	Solid Line			Printed Line				Metallic Line		Acoustic Line	
					White	Gray	Black	Aluminum	Champagne	Pinegray	Dark Olive	Aluminum	Brushed Stainless steel	White	Aluminum

5 Handles															
793060	Solid center handle	RAU-PVC	2.5 m	8 lg	9010	7035	9011								
779920	Printed center handle	RAU-PP	2.5 m	8 lg				7194							
779930	Aluminum center handle with adapter profile	Alu/RAU-PP	2.5 m	8 lg								230L (E6EV1)			
793014	Stainless steel center handle with adapter profile	Alu	2.5 m	8 lg									360L		
779960	Glide for center handle Art. No. 779930	PA		10 p		7035									

6 Cover profiles															
779350	Solid cover profile	RAU-PVC	2.5 m	8 lg	9010	7035	9011								
779360	Printed cover profile	RAU-PVC	2.5 m	8 lg				5427	1100E						
779650	Aluminum cover profile	Alu	2.5 m	8 lg								230L (E6EV1)			
793004	Stainless steel cover profile	Alu	2.5 m	8 lg									360L		
779590	Aluminum frame cover profile lower part	Alu	2.5 m	8 lg								mill-finish (E0/CO)			
779600	Solid frame cover profile upper part	RAU-PVC	2.5 m	8 lg	9010	7035	9011								
779610	Printed frame cover profile upper part	RAU-PVC	2.5 m	8 lg				5427							
793069	Aluminum frame cover profile	Alu	2.5 m	8 lg								230L (E6EV1)			
793078	Frame stainless steel cover profile	Alu	2.5 m	8 lg									360L		
793026	PP Printed cover profile	RAU-PP	2.5 m	8 lg						1243W	1705W				7194
793045	PP Solid cover profile	RAU-PP	2.5 m	8 lg										V1865	

7 Counterbalance Mechanisms															
779640	Caddy brake (Installation right)	RAU-POM		10 pcs			9011								
779680	Vertical brake E23	RAU-POM		20 p			9011								
779970	C6 Vertical counterbalance mechanism	RAU-POM		5 pcs											
779310	C3 – width 400 mm			1 pcs											
779840	C3 – width 600 mm			1 pcs											
779850	C3 – width 800 mm			1 pcs											
223918	C3 – width 36"			1 pcs											
223919	C3 – width 42"			1 pcs											
223920	C3 – width 48"			1 pcs											
779320	Extension C3 + guide roller wheel set *			1p+ 1 pcs											

8 Accessories															
793039	Adhesive tape 50 m			1 pcs											
779790	Lock			20 pcs											
779800	Handle Silver 128 mm			20 pcs											
779810	Handle Silver 192 mm			20 pcs											

lg = lengths, p = pairs, pcs = pieces

For updates to this publication, visit na.rehau.com/resourcecenter

The information contained herein is believed to be reliable, but no representations, guarantees or warranties of any kind are made as to its accuracy, suitability for particular applications or the results to be obtained therefrom. Before using, the user will determine suitability of the information for user's intended use and shall assume all risk and liability in connection therewith.

© 2012 REHAU Printed in Canada