

PRODUCT SUBMITTAL 902

Product: SDR11 Reducer Couplings
Date: 01 January 2018 (supersedes 01 January 2017)

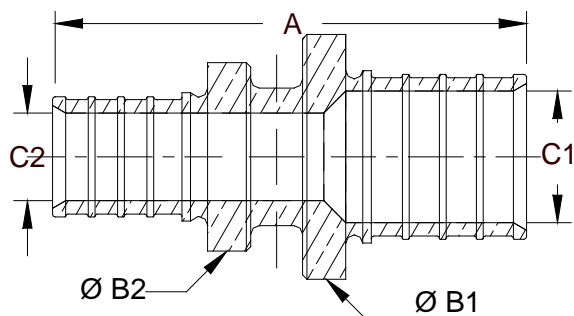

Article No.	Nominal Size mm	A in (mm)	B1 in (mm)	B2 in (mm)	C1 in (mm)	C2 in (mm)
169014-001	32 x 2.9 – 25 x 2.3	2.893 (73.5)	1.575 (40.0)	1.188 (30.2)	0.882 (22.4)	0.701 (17.8)
169017-001	40 x 3.7 – 32 x 2.9	3.425 (87.0)	1.929 (49.0)	1.575 (40.0)	1.063 (27.0)	0.882 (22.4)
169147-001	50 x 4.6 – 40 x 3.7	3.858 (98.0)	2.402 (61.0)	1.929 (49.0)	1.378 (35.0)	1.063 (27.0)
169170-001	50 x 4.6 – 32 x 2.9	3.642 (92.5)	2.402 (61.0)	1.575 (40.0)	1.398 (35.5)	0.882 (22.4)
169148-001	63 x 5.8 – 50 x 4.6	4.606 (117)	2.913 (74.0)	2.402 (61.0)	1.772 (45.0)	1.378 (35.0)
267641-	75 x 6.8 – 63 x 5.8	5.196 (132)	3.543 (90.0)	2.913 (74.0)	2.126 (54.0)	1.772 (45.0)
267651-	90 x 8.2 – 75 x 6.8	5.393 (137)	4.252 (108)	3.543 (90.0)	2.717 (69.0)	2.126 (54.0)
267661-	110 x 10.0 – 90 x 8.2	5.393 (137)	5.118 (130)	4.252 (108)	3.268 (83.0)	2.717 (69.0)

TECHNICAL DESCRIPTION

Material	Machined From Brass/Bronze Rod
----------	--------------------------------

FUNCTIONAL DESCRIPTION

SDR11 compression-sleeve fittings are designed for all heating and snow and ice melting applications as well as hydronic distribution connections. SDR11 compression-sleeve fittings and compression sleeves can be walled in, including applications above the ceiling, or embedded directly in a thermal mass. In both cases, check local code compliance. Installation in thermal mass requires the fittings and sleeves to be wrapped in waterproof, rubber tape or RAUCROSS™ heat shrink tubing to help reduce corrosion caused by the surrounding environment.

Installation is performed with SDR11 compression-sleeve tools. Tapered end of sleeve installs toward fitting. Follow all published installation instructions. Not certified for potable water.

For updates to this publication, visit na.rehau.com/resourcecenter

The information contained herein is believed to be reliable, but no representations, guarantees or warranties of any kind are made as to its accuracy, suitability for particular applications or the results to be obtained therefrom. Before using, the user will determine suitability of the information for user's intended use and shall assume all risk and liability in connection therewith. © 2018 REHAU